

**RIGHT ANGLE PLUG CRIMP TYPE
CABLE 8.07/50**

R117.187.807
SERIES SMB-LOCK

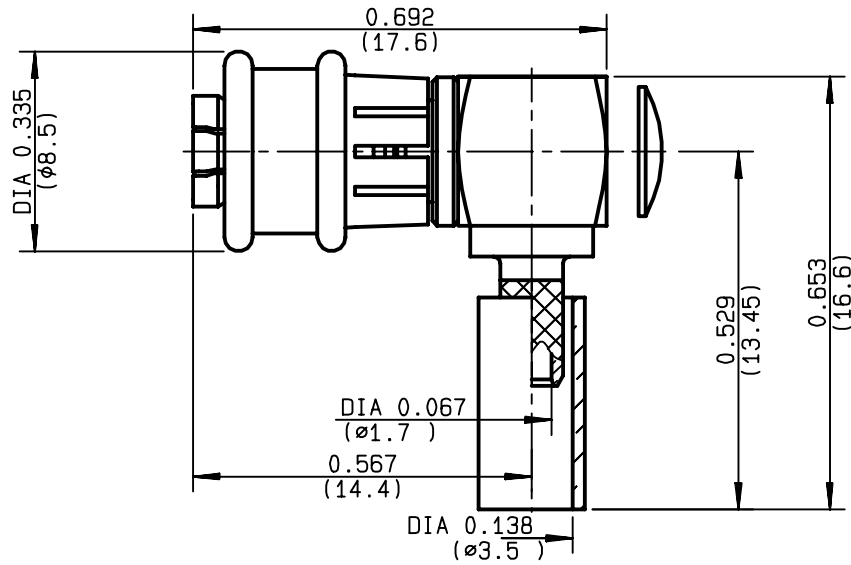

NOMINAL IMPEDANCE	50 Ω	CABLES : K02252D
FREQUENCY RANGE	0-4 GHz	RD 316
TEMPERATURE RATING	-35/+125 °C	
V.S.W.R	1.35 + .04 x F(GHz)Maxi	
RF INSERTION LOSS	.5 √F(GHz) dB Maxi	
VOLTAGE RATING	335 Veff Maxi	
DIELECTRIC WITHSTANDING VOLTAGE	1000 Veff Mini	
INSULATION RESISTANCE	1000 MΩMini	OTHERS CHARACTERISTICS
HERMETIC SEAL	NA Atm.cm ³ /s	CABLE RETENTION 110 N Mini
LEAKAGE (pressurized only)	NA	CENTER CONTACT RETENTION
MECHANICAL DURABILITY	500 Cycles	Axial force - mating end 10 N Mini
WEIGHT	3.5 gr	Axial force - opposite end 10 N Mini
SPECIFICATION		Torque NA cm.N Mini
		RECOMMENDED TORQUES
		Mating NA cm.N
		Panel nut NA cm.N
		Clamp nut NA cm.N

CONNECTOR PARTS	MATERIALS	FINISH	(all values are given in micrometers)
BODY	BRASS	BBR 2	
OUTER CONTACT	BRONZE	BBR 2	
CENTER CONTACT	BERYLLIUM COPPER	GOLD 0.8 OVER COPPER 0.5	
INSULATOR	PTFE	-	
GASKET	-	-	
OTHERS PIECES	DELTRIN (POM)	-	

ISSUE 9805A02	CREATION DATE 08/12/1997	FILE PART-NUMBER EPC 97-08
-------------------------	------------------------------------	--------------------------------------



GUERIN

The information given here is subject to change without notice.
Design changes may be in order to improve the product .

Connect to the future



R117.187.807

ISSUE **9805A02** SERIES **SMB-LOCK**

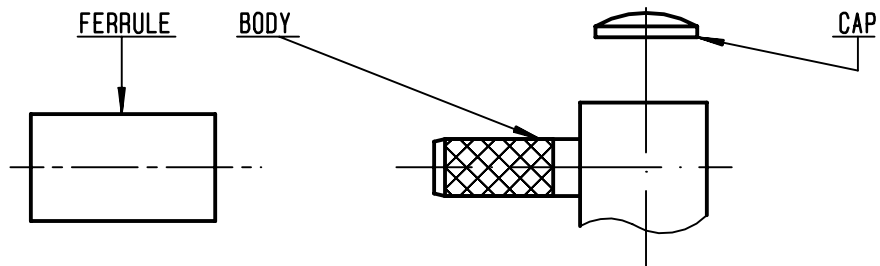

①

Slide ferrule onto cable .
Strip the cable .
-
-

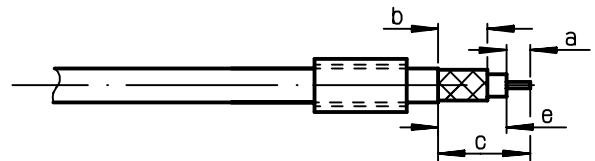

Stripping	a	b	c	d	e
inch	0.059	0.213	0.429	0	0.37
mm	1.5	5.4	10.9	0	9.4

②

Fan the braid .
Push connector body under the braid .
Slide ferrule over braid
(in direction F)
-
-

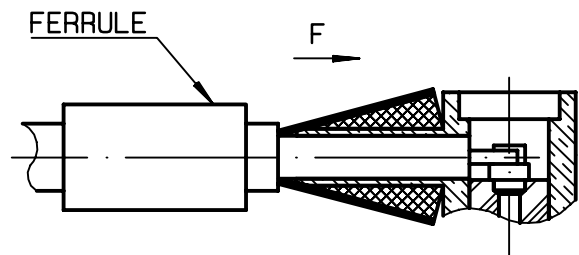

③

Crimp the ferrule with crimping tool R282 271 000 (Hex. : .151) or crimping tool R 282 293 000 (M22520/5-01) + dies R 282 235 037 (M22520/5-37) Solder inner conductor .

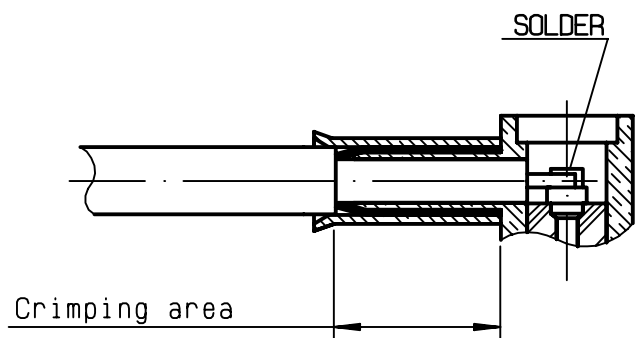

④

Place the cap into body.
Press cap flush or slightly below surface of body assembly .
-
-
-
-
-

